

Blok Desk in Hot Rolled Steel

With a minimal aesthetic, the elegant lines and angles of the **Blok** range of reception desks are specified for office and reception spaces of all sizes, from a selection of modular components which are installed as one highly finished piece. Available as part of the Isomi in Metal collection in lacquered hot rolled steel, copper and brass, the desks are perfectly suited to contemporary public spaces and reception environments.

Key features

Easy to specify modular components

Three height options of 760mm, 950mm and 1100mm as standard

CAD and BIM files available

Illuminated branding, sign-in platform and storage units available as options

Reception desks can be handed to the left or right

DDA modules available

Inset black matt laminate worktop, LED light trough and cable management included as standard

Made in authentic, hand-selected hot rolled steel.

Available in 6–8 weeks (UK), 12-14 weeks (US)



Blok Desk in Hot Rolled Steel Modules

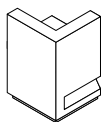

BD01
Left End
W31.5
D34.5
H30/37.5/43.5"

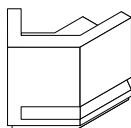

BD02
Left End Angle 45°
W34.5
D34.5
H30/37.5/43.5"

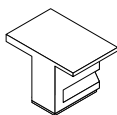

BD03
Left End DDA
W31.5
D46.25
H30"

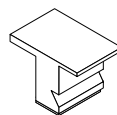

BD04
Straight DDA
W31.5
D46.25
H30"

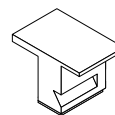

BD05
Right End DDA
W31.5
D46.25
H30"

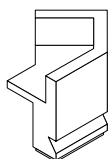

BD06
Right End Angle 45°
W34.5
D34.5
H30/37.5/43.5"

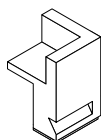

BD07
Right End
W31.5
D34.5
H30/37.5/43.5"

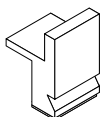

BD08
Straight
W31.5
D34.5
H30/37.5/43.5"

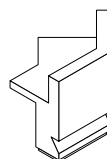

BD09
Angle 45°
W34.5
D34.5
H30/37.5/43.5"

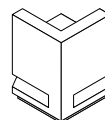

BD10
Angle 90°
W34.5
D34.5
H30/37.5/43.5"

Accessories

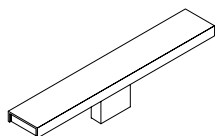

Blok
Sign-in platform/light
Powder coated aluminium
W60
D10
H13.75"



TB
Translucent branding
W31.5
H8"
(recommended dimensions)



LS
LED skirting

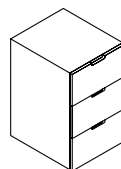

DU
Drawer unit
W15.75
D10/20.5
H27.5"

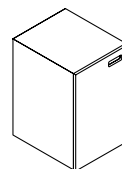

CU
Cupboard unit
W15.75
D10/20.5
H27.5"

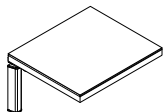

Electric sit-stand desk
H25.5-37.5"
D23.5-118"

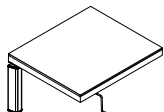

Manual sit-stand desk
H25.5-37.5"
D23.5-118"



Infrared heating panel



**Blok Desk in Hot Rolled Steel
Configurations**



Configuration 1

W63
D34.5
H30/37.5/43.5"



Configuration 2

W94.5
D34.5/46.25
H30/37.5/43.5"



Configuration 3

W94.5
D34.5
H30/37.5/43.5"



Configuration 4

W126
D34.5/46.25
H30/37.5/43.5"



Configuration 5

W157.5
D34.5/46.25
H30/37.5/43.5"

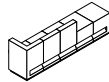

Configuration 6

W189
D34.5/46.25
H30/37.5/43.5"

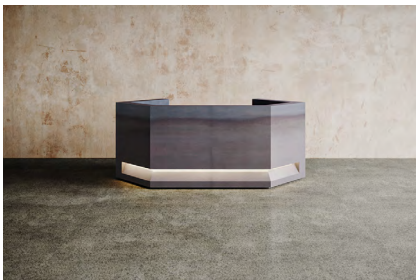
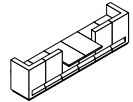

Configuration 7

W107.5
D34.5/46.25
H30/37.5/43.5"



Configuration 8

W62.75/62.75
D34.5
H30/37.5/43.5"



Configuration 9

W94.5/62.75
D34.5/46.25
H30/37.5/43.5"

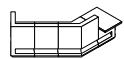

Illustrations above relate to the product at 37.5" height.



Configuration 10

W97.5/97.5
D34.5
H30/37.5/43.5"

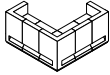

Configuration 11

W97.5/97.5
D34.5/46.25
H30/37.5/43.5"

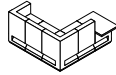

Blok Palette

Metal



Hot Rolled Steel
M001



Copper
M002



Copper
M003

Alternative colours are available on request. For a full list of colour options please download our colour chart. The printed representation of colours may vary from actual samples. Always request actual samples before ordering.
